

# SV-M60820

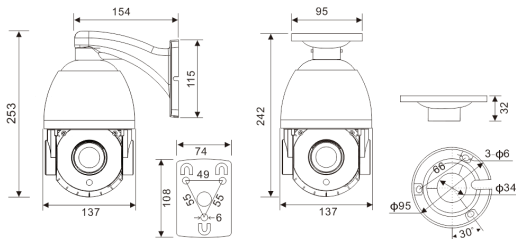

## Dimensions



## Product Summary

- 1/2.8" Sony low-light CMOS sensor
- 4K 8MP resolution 3840 x 2160 output
- Low illumination 0.001Lux
- 20x optical zoom lens
- Day/Night AWB/MWB,BLC, HLC, 2D/3D-DNR, Shutter, IR-UT
- D-WDR, Mirror, rotate, Defogging
- Multiply Style OSD Overlay, Motion Detection, Privacy Mask
- RTSP and Onvif 17.06 compatible with many third-party NVR
- H.264/H.265 dual-stream media server
- Easy-to-use P2P Cloud service
- Support user authentication, video data encryption
- Support Alarm Snapshot to Email and FTP
- Multiply WEB browser IE, Firefox 32bit ESR, PC Client, Mobile APP remote access
- Lightning protection 4000V
- Strong water-proof housing IP66
- 8 pcs Array IR Led, IR distance 80-100 meters

## Major Specifications

\* Specifications are subject to change without prior notice.

Model Name		SV-M60820
Camera	Image Sensor	1/2.8" Sony CMOS
	Effective Pixels	8 megapixels
	Electronic Shutter	AUTO, 1/25s ~ 1/100000s
	Min. Illumination	0.01Lux@F1.2(AGC ON), 0Lux IR on
	Day/Night	Auto/Color/(B/W)/Timing
	WDR	Digital WDR
	White Balance	Auto/Manual
	BLC /HLC	Support
	DNR	2D/3D DNR
Other	AGC, Motion Detection, Privacy Mask, Flip, OSD overlay	
Encode	Video Standard	H.264/H.265
	Video Resolution	MainStream: 20fps@8MP(3840x2160), 30fps@6MP(3072x2048)/5MP(2592x1944)/4MP/3MP/1080P/720P, etc.
	Video Bitrates	512Kbps - 12Mbps, VBR/CBR
	Audio Standard	G.711-u/G.711-a
	Built-in Mic	Optional
IR Led	IR Led	8pcs array IR Led (4 near + 4 far)
	IR Distance	80-100 M
Lens	Focal length	4.7-94mm
	IRIS	F1.6-3.5
	View angle	64 - 2.9 °
	Zoom	20x optical zoom
Optional Function		High power PoE
PTZ	Pan/Tilt Range	Pan: 0° ~ 360°; Tilt: 0° ~ 90°
	Preset Point	128
	Control Speed	Pan: 0.5° ~ 40° /s; Tilt: 0.5° ~ 40° /s
	A-B Scanning	Support
	Auto Cruising	Support 8 groups
	Power on Action	Preset/Scan/Cruise
	Power-off Recovery	Support
Network Services	Protocol	HTTP/RTSP/FTP/NFS/SMTP/DHCP/NTP, etc.
	P2P	Yes
	Web	IE, Firefox (32bit esr), etc.
	Media	CMS, Android, IOS
General	ONVIF	17.06 compatible
	Network Port	1-RJ45, 100Mbps, PoE 48V in
	Power Supply	12 VDC ± 10% 2A
	Power Consumption	< 20 W
	Operating Temp.	-30℃ - (+60)℃, 10% - 90%RH
	Size	Φ137(mm) × 234(mm)
Weight	2.3kg	